

Three-year Plan of Allocation and Destination of Immovables 2025-2028

| School | Street Address | City, Town, Borough | Postal Code | Premises at the Disposal of the School | Enrollment 2024-2025 | 2025-2026 Enrollment Forecast | 2026-2027 Enrollment Forecast | 2027-2028 Enrollment Forecast | Level | Capacity |
|----------------------------|----------------------------|--------------------------------------|-------------|--|----------------------|-------------------------------|-------------------------------|-------------------------------|-------|----------|
| | | | | The entirety of the premises is at the disposal of the school/centre from August 15 to June 26 except for gymnasiums, auditoriums and outdoor fields after 6 pm and on weekends. Additional rooms not available are: | | | | | | |
| Allion | 140-9th Avenue | LaSalle, borough of Montreal, QC | H8P 2N9 | Downstairs office areas of S109 used by Lasalle for Air Cadet | 316 | Elementary K-6 | Elementary K-6 | Elementary K-6 | E | 398 |
| | | | | Using classrooms number B207 & B-208 at LCCHS | | 319 | 311 | 308 | K-6 | |
| Beacon Hill | 170 Alton Drive | Beaconsfield, QC | H9W 2Z3 | | 274 | Elementary K-6 | Elementary K-6 | Elementary K-6 | E | 348 |
| | | | | | | 273 | 256 | 254 | K-6 | |
| Beaconsfield High | 250 Beaurepaire Drive | Beaconsfield, QC | H9W 5G7 | | 990 | Secondary 1-5 | Secondary 1-5 | Secondary 1-5 | S | 1200 |
| | | | | | | 984 | 993 | 1022 | 1-5 | |
| Beechwood | 13155 Shelborne | Pierrefonds, borough of Montreal QC | H9A 1L4 | | 233 | Elementary K-6 | Elementary K-6 | Elementary K-6 | E | 288 |
| | | | | | | 235 | 235 | 243 | K-6 | |
| Beurling Academy | 6100 Champlain Boulevard | Verdun, borough of Montreal, QC | H4H 1A5 | YMCA Room | 227 | Secondary 1-5 | Secondary 1-5 | Secondary 1-5 | S | 450 |
| | | | | Shared facility with Verdun Adult & Career Centre (see appendix) | | 236 | 224 | 215 | 1-5 | |
| Birchwood | 1325 rue Jolicoeur | Saint-Lazare, QC | J7T 1Z4 | | 351 | Elementary K-6 | Elementary K-6 | Elementary K-6 | E | 393 |
| | | | | | | 358 | 358 | 366 | K-6 | |
| Children's World Academy | 2241 Ménard | LaSalle, borough of Montreal, QC | H8N 1J4 | | 515 | Elementary K-6 | Elementary K-6 | Elementary K-6 | E | 530 |
| | | | | | | 515 | 513 | 508 | K-6 | |
| Christmas Park | 422 Beaconsfield Boulevard | Beaconsfield, QC | H9W 4B7 | REACH Program | 136 | Elementary K-6 | Elementary K-6 | Elementary K-6 | E | 429 |
| | | | | | | 161 | 158 | 153 | K-6 | |
| Clearpoint | 17 Cedar | Pointe-Claire, QC | H9S 4X9 | | 383 | Elementary K-6 | Elementary K-6 | Elementary K-6 | E | 441 |
| | | | | | | 383 | 373 | 347 | K-6 | |
| Dorset | 106 Dorset | Baie d'Urfé, QC | H9X 2Z6 | | 268 | Elementary K-6 | Elementary K-6 | Elementary K-6 | E | 286 |
| | | | | | | 268 | 254 | 241 | K-6 | |
| Dorval | 1750 Carson | Dorval, QC | H9S 1N3 | | 407 | Elementary K-6 | Elementary K-6 | Elementary K-6 | E | 441 |
| | | | | | | 408 | 394 | 392 | K-6 | |
| Edgewater | 220 Cardinal-Léger | Pincourt, QC | J7W 3Y5 | | 424 | Elementary K-6 | Elementary K-6 | Elementary K-6 | E | 428 |
| | | | | | | 428 | 433 | 428 | K-6 | |
| Evergreen | 2625 du Bordelais | St-Lazare, QC | J7T 2Z9 | | 357 | Elementary K-6 | Elementary K-6 | Elementary K-6 | E | 348 |
| | | | | | | 365 | 369 | 368 | K-6 | |
| Forest Hill Junior | 1950 Chanterel | St-Lazare, QC | J7T 3C2 | | 319 | Elementary K-2 | Elementary K-2 | Elementary K-2 | E | 312 |
| | | | | | | 318 | 310 | 310 | K-2 | |
| Forest Hill Senior | 1449 Bédard | St-Lazare, QC | J7T 3B4 | | 440 | Elementary 3-6 | Elementary 3-6 | Elementary 3-6 | E | 432 |
| | | | | | | 438 | 446 | 433 | 3-6 | |
| Horizon High | 90 Jubilee Square | Pointe Claire, Qc | H9R 1M3 | FSSTT Rooms, Transitions & Edventure programs | 100 | Secondary 2-5 | Secondary 2-5 | Secondary 2-5 | S | 220 |
| | | | | Literacy Unlimited room #13, Lease for caretaker apartment | | 100 | 100 | 100 | 2-5 | |
| John Rennie High | 501 Saint Jean Boulevard | Pointe-Claire, QC | H9R 3J5 | Pro Action Hockey Association Room | 1250 | Secondary 1-5 | Secondary 1-5 | Secondary 1-5 | S | 1650 |
| | | | | WILBA storage space | | 1258 | 1223 | 1180 | 1-5 | |
| Kingsdale Academy | 4381 King | Pierrefonds, borough of Montreal, QC | H9H 2E8 | | 266 | Elementary K-6 | Elementary K-6 | Elementary K-6 | E | 417 |
| | | | | | | 276 | 264 | 253 | K-6 | |
| Lakeside Academy | 5050 Sherbrooke | Lachine, borough of Montreal, QC | H8T 1H8 | Club Zone de Lachine room TBD, PEF #124A | 429 | Secondary 1-5 | Secondary 1-5 | Secondary 1-5 | S | 1150 |
| | | | | Classroom numbers 111, 113, 114, 115, 116 & 127 used by Maple Grove , Archive Rooms rooms 110- 112, Room 120 Heart and Hands Clinic | | 427 | 427 | 450 | 1-5 | |
| LaSalle Community Comp. HS | 240, 9th Avenue | LaSalle, borough of Montreal, QC | H8P 2N9 | Allion using classrooms B-207 & B-208 | 742 | Secondary 1-5 | Secondary 1-5 | Secondary 1-5 | S | 1247 |
| | | | | TLC daycare room C-193 & C-195 | | 752 | 733 | 722 | 1-5 | |
| LaSalle Elementary Junior | 8340 David-Boyer | LaSalle, borough of Montreal, QC | H8N 2A1 | | 275 | Elementary K-2 | Elementary K-2 | Elementary K-2 | E | 300 |
| | | | | | | 292 | 286 | 289 | K-2 | |
| LaSalle Elementary Senior | 1555 Rancourt | LaSalle, borough of Montreal, QC | H8N 1R7 | Storage space used by Lasalle borough | 320 | Elementary 3-6 | Elementary 3-6 | Elementary 3-6 | E | 504 |
| | | | | | | 330 | 339 | 344 | 3-6 | |

Three-year Plan of Allocation and Destination of Immovables 2025-2028

| | | | | | | | | | | |
|----------------------------|-----------------------------|--------------------------------------|---------|---|------|-----------------------|-----------------------|-----------------------|----------|------|
| Macdonald High | 17 Maple | Ste-Anne-de-Bellevue, QC | H9X 2E5 | | 916 | Secondary 1-5 906 | Secondary 1-5 900 | Secondary 1-5 910 | S 1-5 | 975 |
| Maple Grove | 740-52 nd Avenue | Lachine, borough of Montreal, QC | H8T 2X6 | Classroom numbers 111, 113, 114, 115, 116 & 127 in Lakeside | 333 | Elementary K-6 351 | Elementary K-6 347 | Elementary K-6 358 | E K-6 | 405 |
| Margaret Manson | 18750 Elkas | Kirkland, QC | H9J 4C1 | | 168 | Elementary K-6 171 | Elementary K-6 158 | Elementary K-6 149 | E K-6 | 393 |
| Mount Pleasant | 97 Mount Pleasant | Hudson, QC | J0P 1H0 | | 311 | Elementary K-6 306 | Elementary K-6 315 | Elementary K-6 331 | E K-6 | 324 |
| New Schools 1 & 2 | Vaudreuil-Soulanges | | | Authorization to build 2 new elementary schools off-island | | | | | K-6 | 500 |
| Pierre Elliott Trudeau | 490 Bourget | Vaudreuil-Dorion, QC | J7V 6N2 | | 299 | Elementary K-6 301 | Elementary K-6 297 | Elementary K-6 301 | E K-6 | 372 |
| Pierrefonds Community High | 13800 Pierrefonds Boulevard | Pierrefonds, borough of Montreal, QC | H9A 1A7 | Shared facility with West Island Career Center (see appendix) Pierrefonds gym storage, FTQ Local 800 Rooms, YMCA | 744 | Secondary 1-5 784 | Secondary 1-5 759 | Secondary 1-5 754 | S 1-5 | 1100 |
| Riverview | 971 Riverview | Verdun, borough of Montreal, QC | H4H 2C3 | CLC Rooms, CPE Riverview Rooms | 303 | Elementary K-6 304 | Elementary K-6 326 | Elementary K-6 338 | E K-6 | 381 |
| Saint Anthony | 17750 Meloche | Pierrefonds, borough of Montreal, QC | H9J 3P9 | | 275 | Elementary K-6 275 | Elementary K-6 268 | Elementary K-6 261 | E K-6 | 393 |
| Saint Charles | 4331 Saint Anne | Pierrefonds, borough of Montreal, QC | H9H 4G7 | | 281 | Elementary K-6 277 | Elementary K-6 267 | Elementary K-6 269 | E K-6 | 372 |
| Saint Edmund | 115 Beaconsfield Boulevard | Beaconsfield, QC | H9W 3Z8 | | 352 | Elementary K-6 352 | Elementary K-6 347 | Elementary K-6 340 | E K-6 | 393 |
| Saint John Fisher Junior | 87 Belmont | Pointe-Claire, QC | H9R 2N7 | SSD Occupational Therapist rooms # 18 and 22 | 241 | Elementary K-2 238 | Elementary K-2 240 | Elementary K-2 255 | E K-2 | 392 |
| Saint John Fisher Senior | 121 Summerhill | Pointe-Claire, QC | H9R 2L8 | IASS Room | 286 | Elementary 3-6 283 | Elementary 3-6 283 | Elementary 3-6 260 | E 3-6 | 528 |
| Saint Patrick | 261 Shamrock | Pincourt, QC | J7W 3W5 | | 454 | Elementary K-6 471 | Elementary K-6 463 | Elementary K-6 470 | E K-6 | 620 |
| Saint Thomas High | 111 Broadview | Pointe-Claire, QC | H9R 3Z3 | Garage used by School Board | 1137 | Secondary 1-5 1131 | Secondary 1-5 1189 | Secondary 1-5 1224 | S 1-5 | 1375 |
| Sherbrooke Academy Junior | 230 Sherbrooke | Beaconsfield, QC | H9W 1P5 | | 176 | Elementary K-2 176 | Elementary K-2 163 | Elementary K-2 156 | E K-2 | 312 |
| Sherbrooke Academy Senior | 313 Windermere | Beaconsfield, QC | H9W 1W1 | Room #124 & 126 Magic Circle Nursery School | 213 | Elementary 3-6 213 | Elementary 3-6 210 | Elementary 3-6 209 | E 3-6 | 426 |
| Soulanges | 1135 Saint Georges | Saint-Télesphore, QC | J0P 1Y0 | | 28 | Elementary K-6 31 | Elementary K-6 29 | Elementary K-6 30 | E K-6 | 35 |
| Springdale | 150 Hyman | Dollard-des-Ormeaux, QC | H9B 1L6 | | 191 | Elementary K-6 184 | Elementary K-6 181 | Elementary K-6 169 | E K-6 | 455 |
| Sunshine Academy | 65 Sunshine | Dollard-des-Ormeaux, QC | H9B 1G9 | | 276 | Elementary K-6 290 | Elementary K-6 290 | Elementary K-6 288 | E K-6 | 393 |
| Terry Fox | 13350 Purcell | Pierrefonds, borough of Montreal, QC | H8Z 1P7 | REACH Program | 335 | Elementary K-6 334 | Elementary K-6 331 | Elementary K-6 325 | E K-6 | 455 |
| Verdun Elementary | 610 Desmarchais | Verdun, borough of Montreal, QC | H4H 1S6 | Room 11 and 12 Heart and Hands Pediatric Clinic Rising Sun Daycare rooms, REACH Program | 183 | Elementary K-6 206 | Elementary K-6 198 | Elementary K-6 197 | E K-6 | 821 |
| Westpark | 6 Howard | Dollard-des-Ormeaux, QC | H9A 2L2 | | 494 | Elementary K-6 494 | Elementary K-6 465 | Elementary K-6 455 | E K-6 | 634 |
| Westwood Junior | 2800 du Bordelais | Saint-Lazare, QC | J7T 3E3 | Point of service for Place Cartier and Gordon Robertson | 471 | Secondary 1-2 472 | Secondary 1-2 495 | Secondary 1-2 505 | S 1-2 | 750 |
| Westwood Senior | 69 Cote Saint Charles | Hudson, QC | J0P 1H0 | Point of service for Place Cartier and Gordon Robertson | 730 | Secondary 3-5 736 | Secondary 3-5 717 | Secondary 3-5 725 | S 3-5 | 1020 |
| Wilder Penfield | 551 Westminster | Dollard-des-Ormeaux, QC | H9G 1E8 | | 305 | Elementary K-6 311 | Elementary K-6 310 | Elementary K-6 303 | E K-6 | 393 |

Three-year Plan of Allocation and Destination of Immovables 2025-2028

| Centre | Street Address | City, Town, Borough | Postal Code | Premises Not at the Disposal of the Centre/Comments | Enrollment 2024-2025 | Usage 2025-2026 | Usage 2026-2027 | Usage 2027-2028 | Level |
|---|--------------------------|----------------------------------|-------------|--|----------------------|-----------------------|-----------------------|-----------------------|-------|
| Gordon Robertson Beauty Academy | 240 Bearepaire Drive | Beaconsfield, QC | H9W 6G4 | Rooms available for use for Adult Education classes when not otherwise occupied as a point of service for Place Cartier, Points of Service at Westwood Junior and Senior | 160 | Vocational Ed. Centre | Vocational Ed. Centre | Vocational Ed. Centre | V\A |
| Pearson Adult & Career Centre – Adult Education | 8300 George | LaSalle, borough of Montreal, QC | H8P 1E5 | PACC Vocational Education Rooms Point of service at Pearson Electrotechnology Center, 5000 Rene-Huguet, Lachine Qc H8T 1M7 | 650 | Adult Ed. Centre | Adult Ed. Centre | Adult Ed. Centre | A |
| Pearson Adult & Career-Vocational | 8310 George | LaSalle, borough of Montreal, QC | H8P 1E5 | PACC Adult Education Rooms Annex at International Language Centre/John Killingbeck Pavilion, 150 Seignory, Pointe-Claire, QC H9R 4R5 | 768 | Vocational Ed. Centre | Vocational Ed. Centre | Vocational Ed. Centre | V |
| Pearson Electrotechnology Centre | 5000 René-Huguet | Lachine, borough of Montreal, QC | H8T 1M7 | Rooms available for use for Adult Education classes when not otherwise occupied as a point of service to Pearson Adult and Career Centre | 680 | Vocational Ed. Centre | Vocational Ed. Centre | Vocational Ed. Centre | V\A |
| Place Cartier Adult and Career Centre - Adult Education | 120 Ambassador | Pointe Claire, Qc | H9R 1S8 | Point of service at 257 Beaconsfield blvd, Beaconsfield, Qc H9W 4A5 Point of service after 4 p.m. at Westwood Jr, 2800 du Bordelais, St. Lazare, QC J7T 3E3 and Westwood Sr 69 Cote Saint Charles, Hudson, QC J0P 1H0 Point of service at Gordon Robertson, 240 Bearepaire Drive, Beaconsfield, Qc H9W 6G4 Point of Service at 1925 Brookdale Ave.Dorval, QC H9P 2Y7 Point of Service for ILC John Killingbeck 150 Seignory, Pointe- Claire, Qc H9R 4R5 Point of Service 93 Hymus, Pointe Claire, Qc H9R 1E2 Point of Service 21275 Lakeshore blvd, Ste Anne de Bellevue, Qc H9X 3L9 Pointe of Service 14400 Gouin Ouest, Pierrefonds, Qc H9H 1B1 Point of service at West Island Career Centre, 13700 Pierrefonds Boulevard, Pierrefonds, Qc H9A 1A7 | 590 | Adult Ed. Centre | Adult Ed Centre | Adult Ed Centre | A |
| Place Cartier Adult and Career Centre- Vocational | 120 Ambassador | Pointe Claire, Qc | H9R 1S8 | Point of Service at 1925 Brookdale Ave.Dorval, QC H9P 2Y7 | 51 | Vocational Ed Centre | Vocational Ed Centre | Vocational Ed Centre | V |
| Verdun Adult & Career Centre - Adult | 6050 Champlain Boulevard | Verdun, borough of Montreal, Qc | H4H 1A5 | Shared facility with Beurling Academy (see appendix) Rooms available for use by Vocational education classes when not otherwise occupied. | 0 | Adult Ed Centre | Adult Ed Centre | Adult Ed Centre | A |
| Verdun Adult and Career Centre- Vocational | 6050 Champlain Boulevard | Verdun, borough of Montreal, Qc | H4H 1A5 | Shared facility with Beurling Academy (see appendix). Rooms available for use for Adult Education classes when not otherwise occupied. International Department Career Development Services | 659 | Vocational Ed. Centre | Vocational Ed. Centre | Vocational Ed. Centre | V |

Three-year Plan of Allocation and Destination of Immovables 2025-2028

| | | | | | | | | | |
|---------------------------|-----------------------------|--------------------------------------|---------|--|-----|-----------------------|-----------------------|-----------------------|---|
| West Island Career Centre | 13700 Pierrefonds Boulevard | Pierrefonds, borough of Montreal, QC | H9A 1A7 | Rooms available for use for Adult Education classes when not otherwise occupied. Point of service for Place Cartier Adult and Career Centre. Shared facility with Pierrefonds Community High School (see appendix) | 574 | Vocational Ed. Centre | Vocational Ed. Centre | Vocational Ed. Centre | V |
|---------------------------|-----------------------------|--------------------------------------|---------|--|-----|-----------------------|-----------------------|-----------------------|---|

| Other Immovable | Street Address | City, Town, Borough | Postal Code | Premises Not at the Disposal of the Other Immovable/Comments | Usage 2024-2025 | Usage 2024-2025 | Usage 2025-2026 | Usage 2026-2027 | Level |
|---|-----------------------|----------------------------------|-------------|---|-----------------|--|--|--|-------|
| Annex Place Cartier Adult and Career Centre | 257 Beaconsfield Blvd | Beaconsfield, Qc | H9W 4A5 | Point of Service for Place Cartier Adult and Career Centre | 200 | Adult Ed & Vocational | Adult Ed and Vocational | Adult Ed and Vocational | A |
| International Language Centre/John Killingbeck Pavilion | 150 Seignory | Pointe-Claire, QC | H9R 4R5 | Office space, gym and dormitory used by International Center. Annex to PACC Vocational and rooms available for use for Adult Education classes | n/a | Adult Ed & Vocational | Adult Ed & Vocational | Adult Ed & Vocational | A & V |
| LBPSP Head Office | 1925 Brookdale | Dorval, QC | H9P 2Y7 | Point of service for Place Cartier Adult and Career Centre CPE Les Enfants de Lester B. | n/a | Administrative Centre | Administrative Centre | Administrative Centre | n/a |
| Vacant Building | 55-5th Avenue | LaSalle, borough of Montreal, QC | H8P 2K1 | N.B. Previously Housed Allion Elementary School | n/a | Vacant, or other Board use as required | Vacant, or other Board use as required | Vacant, or other Board use as required | n/a |

Three-year Plan of Allocation and Destination of Immovables 2025-2028

APPENDIX

Beurling Academy - Verdun Adult and Career Center

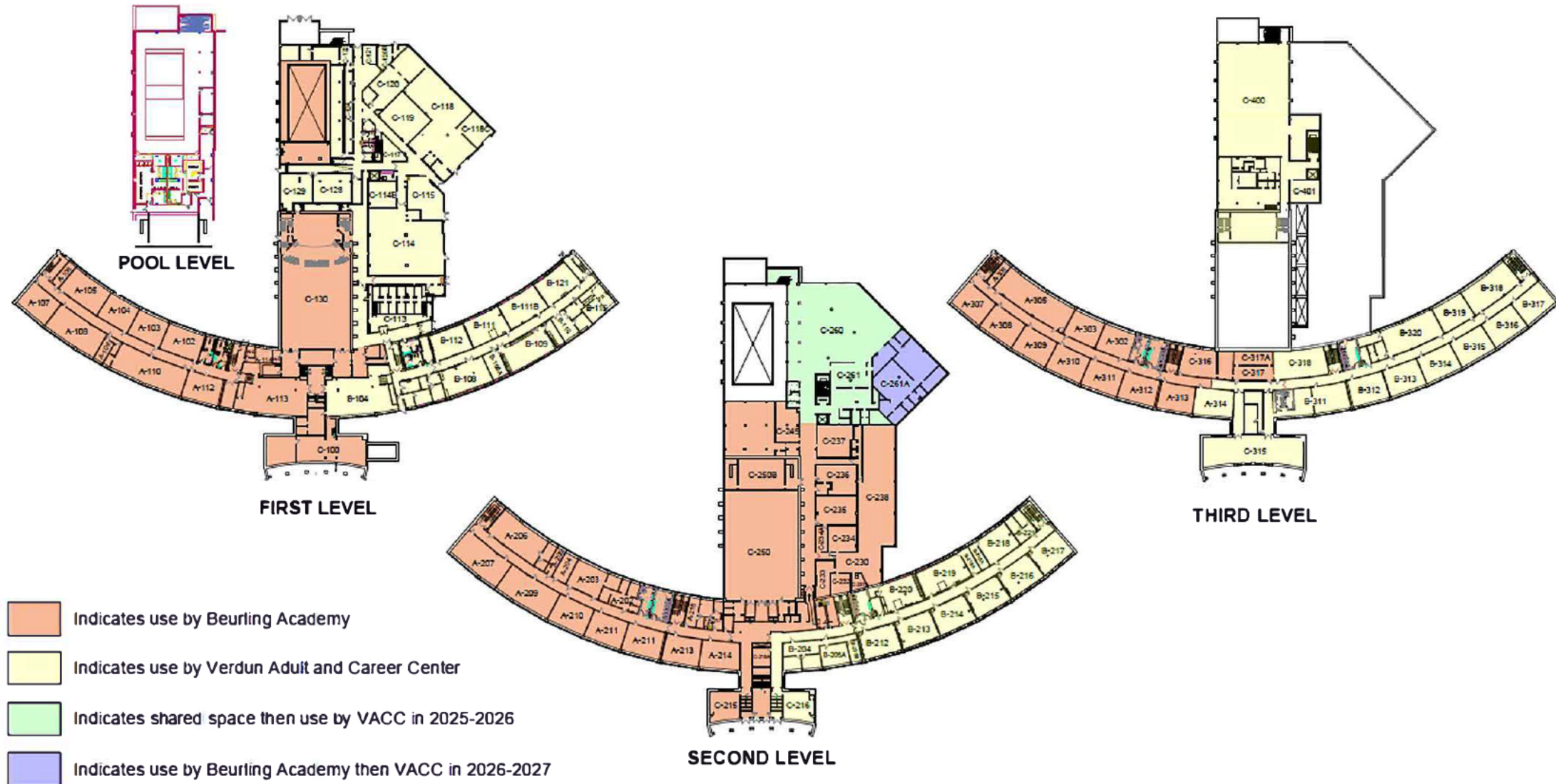

Three-year Plan of Allocation and Destination of Immovables 2025-2028

APPENDIX

Pierrefonds Community High School - West Island Career Centre

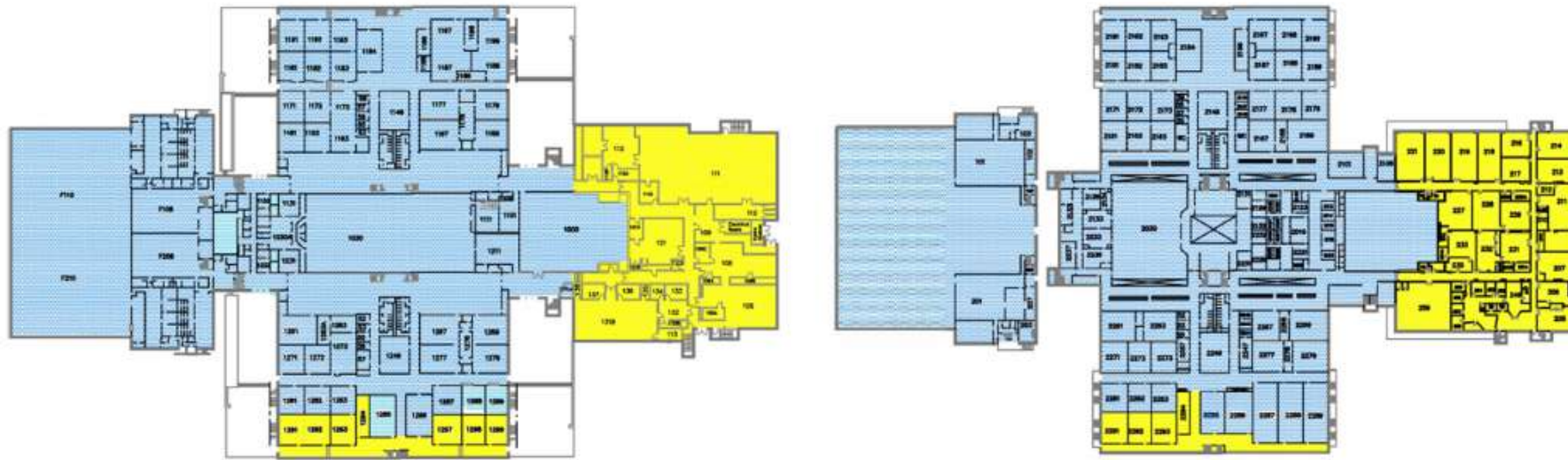

FIRST LEVEL

SECOND LEVEL

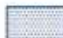
-  Indicates use by West Island Career Centre
-  Indicates use by Pierrefonds Community High School

Three-year Plan of Allocation and Destination of Immovables 2025-2028

APPENDIX

Lakeside Academy-Maple Grove k4/k5-Heart&Hands Clinic

