



Lester B. Pearson School Board
Commission scolaire Lester-B.-Pearson
1925 Brookdale Ave., Dorval, QC, Canada H9P 2Y7
514-422-3000 www.lbpsb.qc.ca

The following is a resolution adopted by the Executive Committee of the Lester B. Pearson School Board at its virtual regular meeting held on April 19, 2022.

Resolution number E-2022-04-#04

Three-Year Plan of Allocation and Destination of Immovables 2022-2025 – Consultation Launch

WHEREAS the school board shall establish a three-year plan for the allocation and destination of its immovables in accordance with section 211 of the Education Act; and

WHEREAS, a draft of said Plan has been developed by the Administration of the School Board; and

WHEREAS in accordance with sections 193 (2) and 211 of the Education Act, the proposed Plan must be submitted for consultation to the municipalities and boroughs whose territory is situated entirely or partially within its own, to the Parents' Committee, to the Central Student Committee, and may be submitted to other consultative partners of the School Board; and

WHEREAS the Executive Committee has been delegated the power to launch the consultation on said Plan in By-law 6:

WHEREFORE IT WAS MOVED BY Commissioner C. Berger AND UNANIMOUSLY RESOLVED:

THAT the proposed Three-Year Plan of Allocation and Destination of Immovables of the Lester B. Pearson School Board 2022-2025 be distributed for consultation to the municipalities or boroughs on its territory, to the Parents' Committee, the Central Student Committee and to the other consultative partners of the School Board during the week of April 20, 2022, with responses to be returned to the Secretariat no later than June 17, 2022; and

THAT the final draft of said Plan be submitted for adoption at the regular meeting of the Council of Commissioners to be held on June 27, 2022.

I certify that this document is an extract from the Minutes of the Lester B. Pearson School Board Executive Committee's meeting held on April 19, 2022; this text is subject to ratification by approval of the Minutes of said meeting at the next meeting of the Executive Committee to be held on May 24, 2022.

This 20th day of April 2022.

Me Geneviève Dugré, Secretary General

Three-year Plan of Allocation and Destination of Immovables 2022-2025

School	Street Address	City, Town, Borough	Postal Code	Premises at the Disposal of the School The entirety of the premises is at the disposal of the school/centre from August 15 to June 26 except for gymnasiums, auditoriums and outdoor fields after 6 pm and on weekends. Additional rooms not available are	Enrollment 2021-2022	2022-2023 Enrollment Forecast	2023-2024 Enrollment Forecast	2024-2025 Enrollment Forecast	Level/Cycle	Capacity
Allion	140-9th Avenue	LaSalle, borough of Montreal, QC	H8P 2N9	Downstairs office areas of S109 entente with LaSalle for Air Cadet	336	Elementary K-6 337	Elementary K-6 326	Elementary K-6 312	E K-6	348
Beacon Hill	170 Alton Drive	Beaconsfield, QC	H9W 2Z3		286	Elementary K-6 278	Elementary K-6 269	Elementary K-6 265	E K-6	348
Beaconsfield High	250 Beaurepaire Drive	Beaconsfield, QC	H9W 5G7		848	Secondary 1-5 834	Secondary 1-5 806	Secondary 1-5 834	S 1-5	1200
Beechwood	13155 Shelborne	Pierrefonds, borough of Montreal QC	H9A 1L4		258	Elementary K-6 252	Elementary K-6 248	Elementary K-6 231	E K-6	288
Beurling Academy	6100 Champlain Boulevard	Verdun, borough of Montreal, QC	H4H 1A5	YMCA Room C-261A Shared facility with Verdun Adult & Career Centre (see appendix)	211	Secondary 1-5 225	Secondary 1-5 230	Secondary 1-5 225	S 1-5	725
Birchwood	1325 rue Jolicoeur	Saint-Lazare, QC	J7T 1Z4		402	Elementary K-6 403	Elementary K-6 367	Elementary K-6 338	E K-6	393
Children's World Academy	2241 Ménard	LaSalle, borough of Montreal, QC	H8N 1J4		496	Elementary K-6 508	Elementary K-6 512	Elementary K-6 513	E K-6	530
Christmas Park	422 Beaconsfield Boulevard	Beaconsfield, QC	H9W 4B7	REACH Program	212	Elementary K-6 198	Elementary K-6 196	Elementary K-6 183	E K-6	429
Clearpoint	17 Cedar	Pointe-Claire, QC	H9S 4X9		442	Elementary K-6 453	Elementary K-6 407	Elementary K-6 390	E K-6	441
Dorset	106 Dorset	Baie d'Urfé, QC	H9X 2Z6		318	Elementary K-6 309	Elementary K-6 280	Elementary K-6 264	E K-6	286
Dorval	1750 Carson	Dorval, QC	H9S 1N3		363	Elementary K-6 374	Elementary K-6 375	Elementary K-6 382	E K-6	441
Edgewater	220 Cardinal-Léger	Pincourt, QC	J7W 3Y5		423	Elementary K-6 420	Elementary K-6 421	Elementary K-6 419	E K-6	428

Evergreen	2625 du Bordelais	St-Lazare, QC	J7T 2Z9			Elementary K-6	Elementary K-6	Elementary K-6	E	348
					317	312	304	309	K-6	
Forest Hill Junior	1950 Chanterel	St-Lazare, QC	J7T 3C2			Elementary K-2	Elementary K-2	Elementary K-2	E	312
					307	304	291	292	K-2	
Forest Hill Senior	1449 Bédard	St-Lazare, QC	J7T 3B4			Elementary 3-6	Elementary 3-6	Elementary 3-6	E	432
					402	419	419	432	3-6	
Horizon High	90 Jubilee Square	Pointe Claire, Qc	H9R 1M3	FSSTT Rooms, Edventure, lease for caretaker apartment	Secondary 2 - 5	Secondary 2-5	Secondary 2-5	Secondary 2-5	S	220
				Literacy unlimited room 13	89	109	109	109	2-5	
John Rennie High	501 Saint Jean Boulevard	Pointe-Claire, QC	H9R 3J5	FTQ Local 800 Rooms, Pro Action Hockey Association Room		Secondary 1-5	Secondary 1-5	Secondary 1-5	S	1650
					1298	1314	1346	1350	1-5	
Kingsdale Academy	4381 King	Pierrefonds, borough of Montreal, QC	H9H 2E8			Elementary K-6	Elementary K-6	Elementary K-6	E	417
					305	278	265	244	K-6	
Lakeside Academy	5050 Sherbrooke	Lachine, borough of Montreal, QC	H8T 1H8	Club Zone de Lachine rooms 113 and 115 Lachine Cadets room 335 Pearson Education Foundation Room 124A Three 4-year-old Maple Grove kindergarten classes # 111,114 & 116 Archive Rooms		Secondary 1-5	Secondary 1-5	Secondary 1-5	S	1150
					500	472	454	470	1-5	
LaSalle Community Comp. HS	240, 9th Avenue	LaSalle, borough of Montreal, QC	H8P 2N9	Catholic Community Services Daycare Rooms lease renewed annually or cancelled at end of term with 6 months' notice		Secondary 1-5	Secondary 1-5	Secondary 1-5	S	1325
					752	826	873	838	1-5	
Lasalle Elementary Junior	8340 David-Boyer	LaSalle, borough of Montreal, QC	H8N 2A1	REACH Program Room		Elementary K-2	Elementary K-2	Elementary K-2	E	300
					283	281	278	284	K-2	
Lasalle Elementary Senior	1555 Rancourt	LaSalle, borough of Montreal, QC	H8N 1R7	Entente with LaSalle - storage space		Elementary 3-6	Elementary 3-6	Elementary 3-6	E	504
					349	343	351	333	3-6	
Macdonald High	17 Maple	Ste-Anne-de-Bellevue, QC	H9X 2E5			Secondary 1-5	Secondary 1-5	Secondary 1-5	S	975
					933	988	1014	1025	1-5	
Maple Grove	740-52 nd Avenue	Lachine, borough of Montreal, QC	H8T 2X6	Three 4-year-old kindergarten classes in Lakeside class # 111, 114 & 116		Elementary K-6	Elementary K-6	Elementary K-6	E	405
					369	377	357	352	K-6	
Margaret Manson	18750 Elkas	Kirkland, QC	H9J 4C1			Elementary K-6	Elementary K-6	Elementary K-6	E	393
					222	214	196	197	K-6	
Mount Pleasant	97 Mount Pleasant	Hudson, QC	J0P 1H0			Elementary K-6	Elementary K-6	Elementary K-6	E	324
					287	296	286	280	K-6	
Pierre Elliott Trudeau	490 Bourget	Vaudreuil-Dorion, QC	J7V 6N2			Elementary K-6	Elementary K-6	Elementary K-6	E	372
					322	310	295	301	K-6	

Pierrefonds Community High	13800 Pierrefonds Boulevard	Pierrefonds, borough of Montreal, QC	H9A 1A7	Shared facility with West Island Career Center (see appendix)	912	Secondary 1-5 879	Secondary 1-5 820	Secondary 1-5 827	S 1-5	1100
Riverview	971 Riverview	Verdun, borough of Montreal, QC	H4H 2C3	CLC Rooms, CPE Riverview Rooms until June 30, 2023	240	Elementary K-6 238	Elementary K-6 244	Elementary K-6 247	E K-6	381
Saint Anthony	17750 Meloche	Pierrefonds, borough of Montreal, QC	H9J 3P9		302	Elementary K-6 288	Elementary K-6 277	Elementary K-6 287	E K-6	393
Saint Charles	4331 Saint Anne	Pierrefonds, borough of Montreal, QC	H9H 4G7		280	Elementary K-6 279	Elementary K-6 269	Elementary K-6 273	E K-6	372
Saint Edmund	115 Beaconsfield Boulevard	Beaconsfield, QC	H9W 3Z8		384	Elementary K-6 358	Elementary K-6 357	Elementary K-6 354	E K-6	393
Saint John Fisher Junior	87 Belmont	Pointe-Claire, QC	H9R 2N7	Occupational Therapist room # 6	233	Elementary K-2 257	Elementary K-2 249	Elementary K-2 258	E K-2	392
Saint John Fisher Senior	121 Summerhill	Pointe-Claire, QC	H9R 2L8	IASS Room	302	Elementary 3-6 294	Elementary 3-6 280	Elementary 3-6 283	E 3-6	528
Saint Patrick	261 Shamrock	Pin court, QC	J7W 3W5		506	Elementary K-6 527	Elementary K-6 505	Elementary K-6 516	E K-6	620
Saint Thomas High	111 Broadview	Pointe-Claire, QC	H9R 3Z3		1333	Secondary 1-5 1333	Secondary 1-5 1286	Secondary 1-5 1262	S 1-5	1375
Sherbrooke Academy Junior	230 Sherbrooke	Beaconsfield, QC	H9W 1P5		191	Elementary K-2 189	Elementary K-2 190	Elementary K-2 191	E K-6	312
Sherbrooke Academy Senior	313 Windermere	Beaconsfield, QC	H9W 1W1	Room #134 Magic Circle Nursery School rented until June 6, 2022. Reapply annually.	179	Elementary 3-6 195	Elementary 3-6 203	Elementary 3-6 206	E K-6	426
Soulanges	1135 Saint Georges	Saint-Télesphore, QC	J0P 1Y0		23	Elementary K-6 25	Elementary K-6 28	Elementary K-6 27	E K-6	35
Springdale	150 Hyman	Dollard-des-Ormeaux, QC	H9B 1L6		219	Elementary K-6 205	Elementary K-6 209	Elementary K-6 206	E K-6	455
Sunshine Academy	65 Sunshine	Dollard-des-Ormeaux, QC	H9B 1G9		262	Elementary K-6 250	Elementary K-6 246	Elementary K-6 247	E K-6	393
Terry Fox	13350 Purcell	Pierrefonds, borough of Montreal, QC	H8Z 1P7	REACH Program Room	291	Elementary K-6 289	Elementary K-6 291	Elementary K-6 304	E K-6	455
Verdun Elementary	610 Desmarchais	Verdun, borough of Montreal, QC	H4H 1S6	Room 11 and 12 Heart and Hands Pediatric Clinic		Elementary K-6	Elementary K-6	Elementary K-6	E	821
				Rising Sun Daycare rooms (20-year lease to 2028)	238	217	202	205	K-6	
Westpark	6 Howard	Dollard-des-Ormeaux, QC	H9A 2L2		561	Elementary K-6 576	Elementary K-6 580	Elementary K-6 567	E K-6	634
Westwood Junior	2800 du Bordelais	Saint-Lazare, QC	J7T 3E3	Point of service for Place Cartier Adult and Career Centre and Gordon Robertson	502	Secondary 1-2 469	Secondary 1-2 444	Secondary 1-2 469	S 1-2	750
Westwood Senior	69 Cote Saint Charles	Hudson, QC	J0P 1H0	Point of Service for Place Cartier Adult and Career Centre and Gordon Robertson	637	Secondary 3-5 709	Secondary 3-5 735	Secondary 3-5 734	S 3-5	1020
Wilder Penfield	551 Westminster	Dollard-des-Ormeaux, QC	H9G 1E8		347	Elementary K-6 320	Elementary K-6 323	Elementary K-6 322	E K-6	393

Three-year Plan of Allocation and Destination of Immovables 2022-2025

Centre	Street Address	City, Town, Borough	Postal Code	Premises Not at the Disposal of the Centre/Comments	Enrollment 2021-2022	Usage 2022-2023	Usage 2023-2024	Usage 2024-2025	Level
Gordon Robertson Beauty Academy	240 Beaufort Drive	Beaconsfield, QC	H9W 6G4	Rooms available for use for Adult Education classes when not otherwise occupied as a point of service for Place Cartier, Points of Service at Westwood Junior and Senior	199	Vocational Ed. Centre	Vocational Ed. Centre	Vocational Ed. Centre	V
Pearson Adult & Career Centre – Adult Education	8300 George	LaSalle, borough of Montreal, QC	H8P 1E5	PACC Vocational Education Rooms Point of service at Pearson Electrotechnology Center, 5000 Rene-Huguet, Lachine Qc H8T 1M7	425	Adult Ed. Centre	Adult Ed. Centre	Adult Ed. Centre	A
Pearson Adult & Career Centre – Vocational	8310 George	LaSalle, borough of Montreal, QC	H8P 1E5	PACC Adult Education Rooms Annex at International Language Centre/John Killingbeck Pavilion, 150 Seigneurie, Pointe-Claire, QC H9R 4R5	635	Vocational Ed. Centre	Vocational Ed. Centre	Vocational Ed. Centre	V
Pearson Electrotechnology Centre	5000 René-Huguet	Lachine, borough of Montreal, QC	H8T 1M7	Rooms available for use for Adult Education classes when not otherwise occupied as a point of service to Pearson Adult and Career Centre	533	Vocational Ed. Centre	Vocational Ed. Centre	Vocational Ed. Centre	V
Place Cartier Adult and Career Centre - Adult Education	120 Ambassador	Pointe Claire, Qc	H9R 1S8	Point of service at 257 Beaconsfield blvd, Beaconsfield, Qc H9W 4A5 Point of service after 4 p.m. at Westwood Jr, 2800 du Bordelais, St. Lazare, QC J7T 3E3 and Westwood Sr 69 Cote Saint Charles, Hudson, QC J0P 1H0 Point of service at Gordon Robertson, 240 Beaufort Drive, Beaconsfield, Qc H9W 6G4 Point of Service at 1925 Brookdale Ave.Dorval, QC H9P 2Y7 Point of Service for ILC John Killingbeck 150 Seigneurie, Pointe- Claire, Qc H9R 4R5 Point of Service 93 Hymus, Pointe Claire, Qc H9R 1E2 Point of Service 21275 Lakeshore blvd, Ste Anne de Bellevue, Qc H9X 3L9 Pointe of Service 14400 Gouin Ouest, Pierrefonds, Qc H9H 1B1 Point of service at West Island Career Centre, 13700 Pierrefonds Boulevard, Pierrefonds, Qc H9A1A7	611	Adult Ed. Centre	Adult Ed Centre	Adult Ed Centre	A
Place Cartier Adult and Career Centre- Vocational	120 Ambassador	Pointe Claire, Qc	H9R 1S8	Point of Service at 1925 Brookdale Ave.Dorval, QC H9P 2Y7	7	Vocational Ed Centre	Vocational Ed Centre	Vocational Ed Centre	V
Verdun Adult & Career Centre - Adult	6050 Champlain Boulevard	Verdun, borough of Montreal, Qc	H4H 1A5	Shared facility with Beurling Academy (see appendix) Rooms available for use by Vocational education classes when not otherwise occupied.	0	Adult Ed Centre	Adult Ed Centre	Adult Ed Centre	A
Verdun Adult and Career Centre- Vocational	6050 Champlain Boulevard	Verdun, borough of Montreal, Qc	H4H 1A5	Shared facility with Beurling Academy (see appendix). Rooms available for use for Adult Education classes when not otherwise occupied.	538	Vocational Ed. Centre	Vocational Ed. Centre	Vocational Ed. Centre	V
West Island Career Centre	13700 Pierrefonds Boulevard	Pierrefonds, borough of Montreal, QC	H9A 1A7	Rooms available for use for Adult Education classes when not otherwise occupied. Point of service for Place Cartier Adult and Career Centre. Shared facility with Pierrefonds Comprehensive High School (see appendix)	656	Vocational Ed. Centre	Vocational Ed. Centre	Vocational Ed. Centre	V

Other Immovable	Street Address	City, Town, Borough	Postal Code	Premises Not at the Disposal of the Other Immovable/Comments	Enrollment 2021-2022	Usage 2022-2023	Usage 2023-2024	Usage 2024-2025	Level/Cycle
Allancroft	265 Allancroft Road	Beaconsfield, Qc	H9W 2R8	Previously was a point of service for Place Cartier	n/a	Vacant building	Vacant building	Vacant building	n/a
Annex Place Cartier Adult and Career Centre	257 Beaconsfield Blvd	Beaconsfield Qc	H9W 4A5	Point of Service for Place Cartier Adult and Career Centre		Adult Ed & Vocational	Adult Ed and Vocational	Adult Ed and Vocatoinal	A
International Language Centre/John Killingbeck Pavilion	150 Seigniory	Pointe-Claire, QC	H9R 4R5	Annex to PACC Vocational and Rooms available for use for Adult Education classes when not otherwise occupied as a point of service for Place Cartier Adult and Career Centre	n/a	International Language Centre	International Language Centre	International Language Centre	V
LBPSB Head Office	1925 Brookdale	Dorval, QC	H9P 2Y7	Point of service for Place Cartier Adult and Career Centre CPE Les Enfants de Lester B.	n/a	Administrative Centre	Administrative Centre	Administrative Centre	n/a
Vacant Building	55-5th Avenue	LaSalle, borough of Montreal, QC	H8P 2K1	<u>N.B.</u> Previously Housed Allion Elementary School	n/a	Vacant, or other Board use as required	Vacant, or other Board use as required	Vacant, or other Board use as required	n/a

Three-year Plan of Allocation and Destination of Immovables 2022-2025

APPENDIX

Beurling Academy - Verdun Adult and Career Center

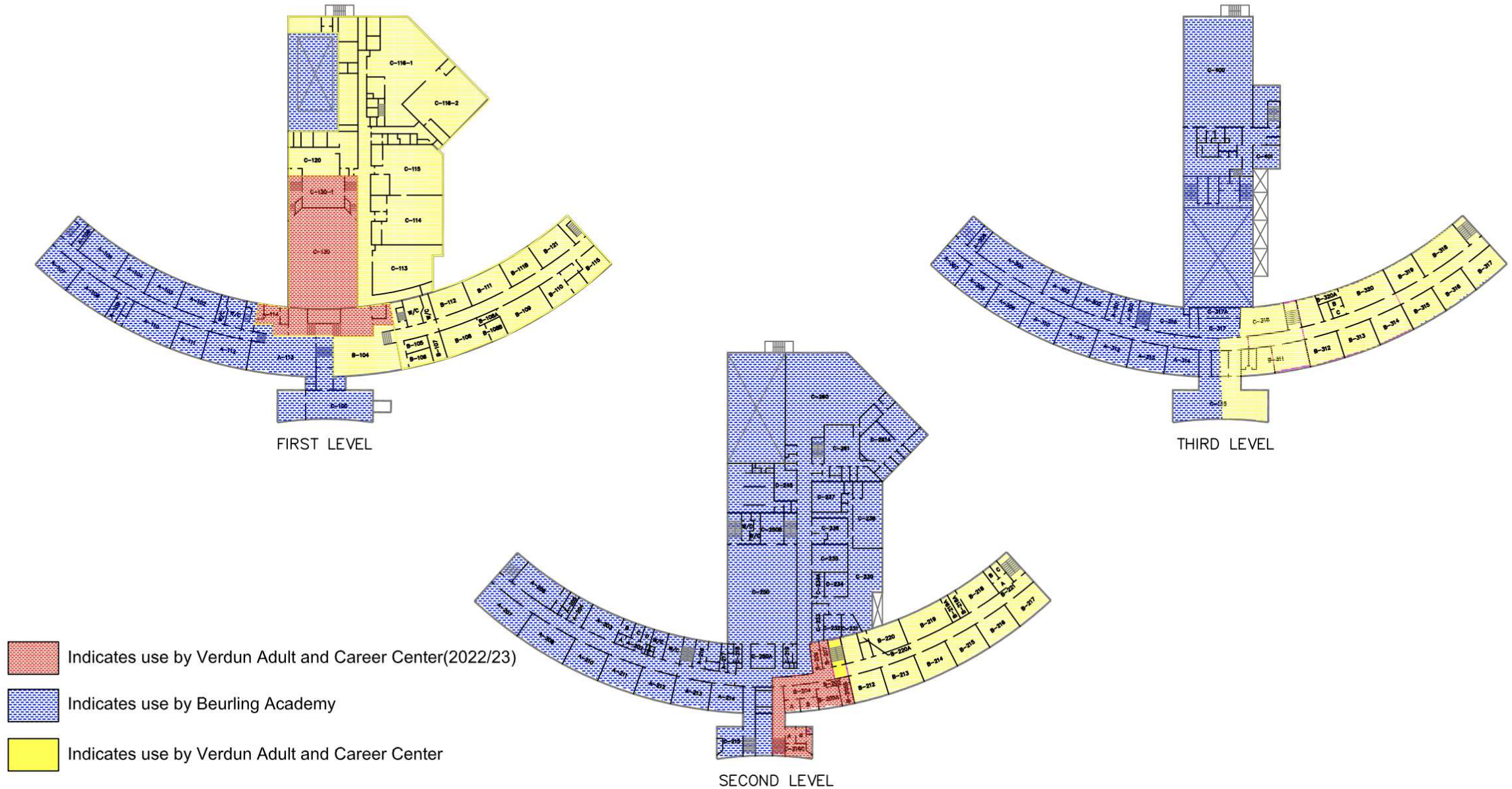

Three-year Plan of Allocation and Destination of Immovables 2022-2025

APPENDIX

Pierrefonds Community High School - West Island Career Centre



FIRST LEVEL

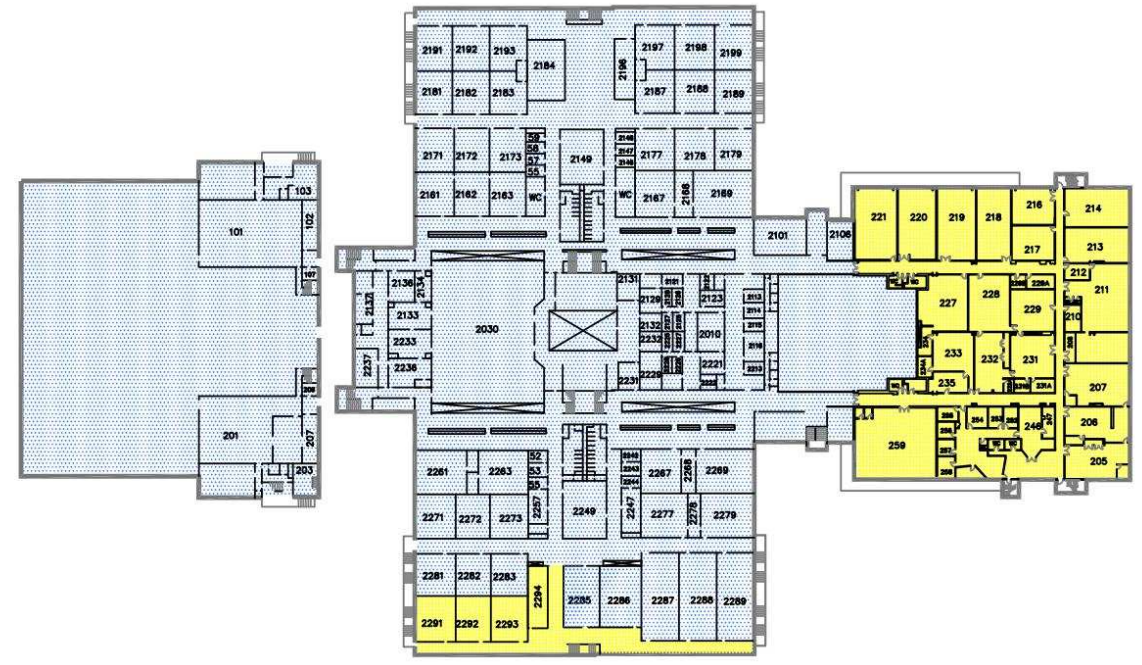

SECOND LEVEL



Indicates use by West Island Career Centre



Indicates use by Pierrefonds Community High School